

REV.	DESCRIPTION	DATE
—	RELEASE	Sep 17, 2003
B	03'0930	Sep 20, 2003
C	03'1006	Oct 08, 2003
D	03'1108	Nov 05, 2003
E	03'1249	Dec 27, 2003
F	04'0207	Feb 05, 2004
G	04'0214	Feb 10, 2004

MATERIALS

- HOUSING :
HI.-TEMP. PLASTIC (UL 94V-0). BEIGE
- TERMINAL:
COPPER ALLOY (t=0.20mm).
GOLD PLATED OVER NICKEL.

SPECIFICATION

- CURRENT RATING : 0.5 A MAX.
- INSULATION RESISTANCE:
1000MΩ MIN AT 500V DC.
- DIELECTRIC WITHSTANDING VOLTAGE:
150V AC R.M.S. FOR ONE MINUTE.
- CONTACT RESISTANCE: 50mΩ MAX.
- OPERATING TEMPERATURE:
-40°C ~ +105°C.

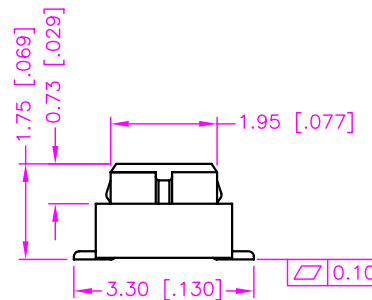
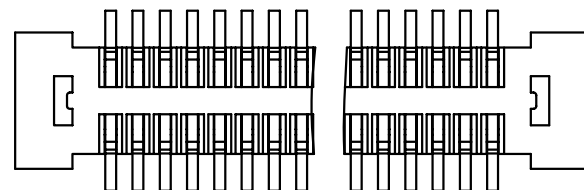
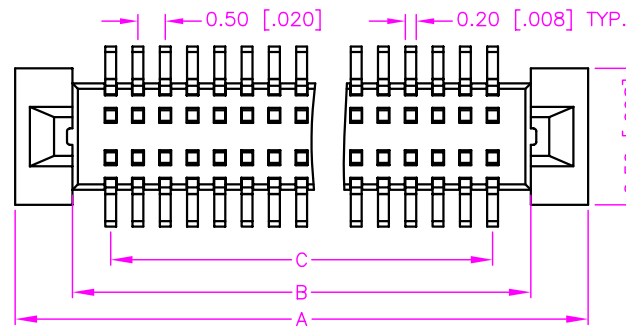

10~20PIN W/RIB

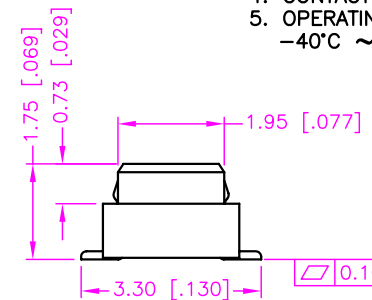

22~100PIN W/O RIB

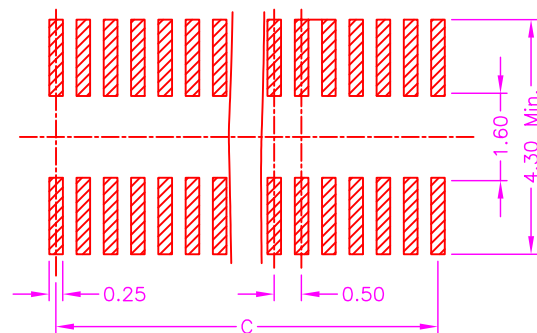

RECOMMENDED P.C.B LAYOUT
TOLERANCE ±0.05
TOP VIEW

ORDERING INFORMATION

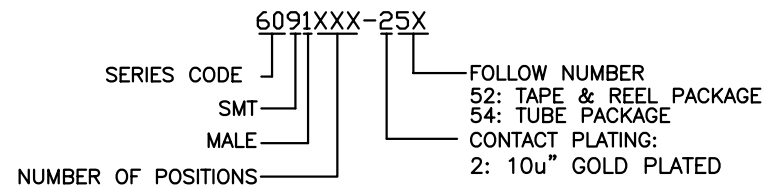

100	28.00 [1.102]	25.90 [1.020]	24.50 [.965]
90	25.50 [1.004]	23.40 [.921]	22.00 [.866]
80	23.00 [.906]	20.90 [.823]	19.50 [.768]
72	21.00 [.827]	18.90 [.744]	17.50 [.689]
70	20.50 [.807]	18.40 [.724]	17.00 [.669]
60	18.00 [.709]	15.90 [.626]	14.50 [.571]
50	15.50 [.610]	13.40 [.528]	12.00 [.472]
40	13.00 [.512]	10.90 [.429]	9.50 [.374]
34	11.50 [.453]	9.40 [.370]	8.00 [.315]
32	11.00 [.433]	8.90 [.350]	7.50 [.295]
30	10.50 [.413]	8.40 [.331]	7.00 [.276]
28	10.00 [.394]	7.90 [.311]	6.50 [.256]
26	9.50 [.374]	7.40 [.291]	6.00 [.236]
24	9.00 [.354]	6.90 [.272]	5.50 [.217]
22	8.50 [.335]	6.40 [.252]	5.00 [.197]
20	8.00 [.315]	5.90 [.232]	4.50 [.177]
18	7.50 [.295]	5.40 [.213]	4.00 [.157]
16	7.00 [.276]	4.90 [.193]	3.50 [.138]
14	6.50 [.256]	4.40 [.173]	3.00 [.118]
12	6.00 [.236]	3.90 [.154]	2.50 [.098]
10	5.50 [.217]	3.40 [.134]	2.00 [.079]
Number Of Position	A	B	C

	MALE	6091XXX-254	6091XXX-252	
	FEMALE	6090XXX-273	6090XXX-271	3.00 [.118]
	MALE	6091XXX-254	6091XXX-252	2.50 [.098]
	FEMALE	6090XXX-254	6090XXX-252	
	TUBE PACKAGE	TAPE PACKAGE	STACKED HEIGHT	

TOLERANCE .0=±0.25 [.010] .00=±0.15 [.006] .000=±0.10 [.004] .0000=±. ANG.=±3'		DRAWER <i>NPBK</i>	ASTRON TECHNOLOGY CORP. NAME B TO B 0.5PH SMT MALE H=2.50, 3.00
CHECK <i>Katherlin</i>		APP'D <i>LJON</i>	
UNITS : mm [inch]		PRODUCT SPEC.	DRAW NO. R6091XXX-252(54)
SCALE NONE	SIZE A4	SHEET 1 OF 1	REV. G