

E	03'0624	Jun 20,2003	REV.	DESCRIPTION	DATE
F	03'0920	Sep 17,2003	-	03'0107	Jan 08,2003
G	03'1124	Nov 14,2003	B	03'0316	Mar 20,2003
H	03'1211	Dec 08,2003	C	03'0453	Apr 28,2003
			D	03'0624	Jun 18,2003

**MATERIALS**

- HOUSING : HI.-TEMP. PLASTIC (UL 94V-0),BEIGE
- TERMINAL: COPPER ALLOY (t=0.20mm). GOLD PLATED OVER NICKEL.

**SPECIFICATION**

- CURRENT RATING : 0.5 A MAX.
- INSULATION RESISTANCE: 1000MΩ MIN AT 50V DC.
- DIELECTRIC WITHSTANDING VOLTAGE: 150V AC R.M.S. FOR ONE MINUTE.
- CONTACT RESISTANCE: 50mΩ MAX.
- OPERATING TEMPERATURE: -40°C ~ +105°C.

100	28.00 [1.102]	25.95 [1.022]	24.50 [.965]
90	25.50 [1.004]	23.45 [.923]	22.00 [.866]
80	23.00 [.906]	20.95 [.825]	19.50 [.768]
72	21.00 [.827]	18.95 [.746]	17.50 [.689]
70	20.50 [.807]	18.45 [.726]	17.00 [.669]
60	18.00 [.709]	15.95 [.628]	14.50 [.571]
50	15.50 [.610]	13.45 [.530]	12.00 [.472]
40	13.00 [.512]	10.95 [.431]	9.50 [.374]
34	11.50 [.453]	9.45 [.372]	8.00 [.315]
32	11.00 [.433]	8.95 [.352]	7.50 [.295]
30	10.50 [.413]	8.45 [.333]	7.00 [.276]
28	10.00 [.394]	7.95 [.313]	6.50 [.256]
26	9.50 [.374]	7.45 [.293]	6.00 [.236]
24	9.00 [.354]	6.95 [.274]	5.50 [.217]
22	8.50 [.335]	6.45 [.254]	5.00 [.197]
20	8.00 [.315]	5.95 [.234]	4.50 [.177]
18	7.50 [.295]	5.45 [.215]	4.00 [.157]
16	7.00 [.276]	4.95 [.195]	3.50 [.138]
14	6.50 [.256]	4.45 [.175]	3.00 [.118]
12	6.00 [.236]	3.95 [.156]	2.50 [.098]
10	5.50 [.217]	3.45 [.136]	2.00 [.079]
Number Of Position	A	B	C

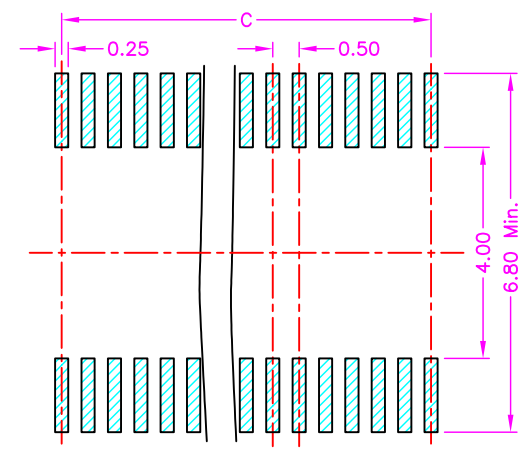
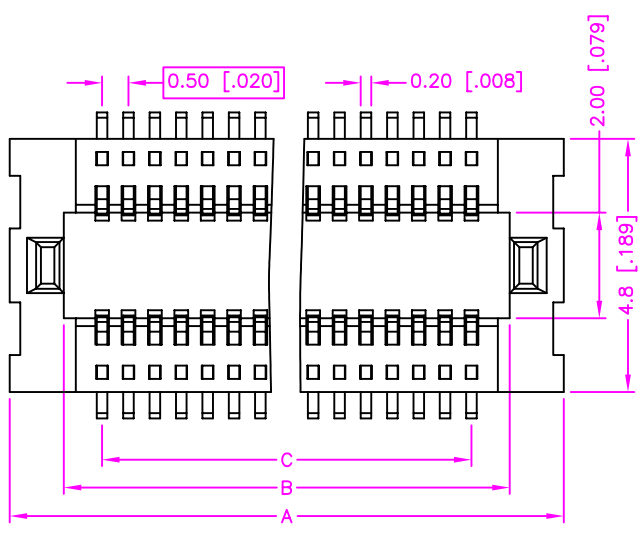

RECOMMENDED P.C.B LAYOUT  
TOLERANCE ±0.05  
TOP VIEW

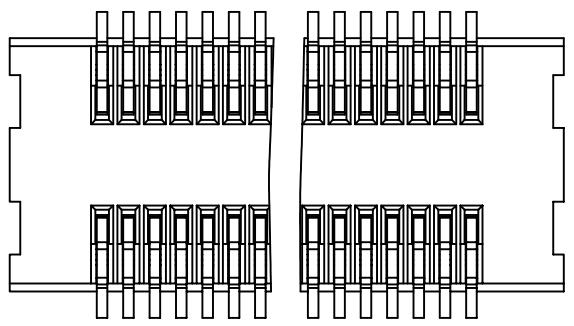
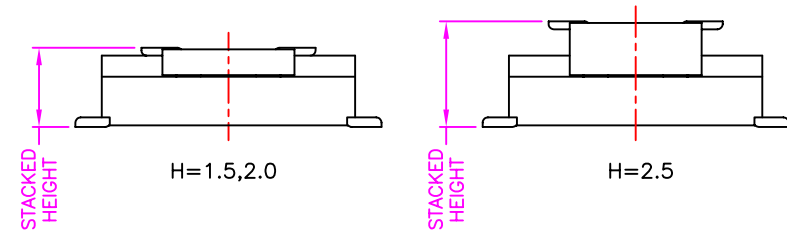
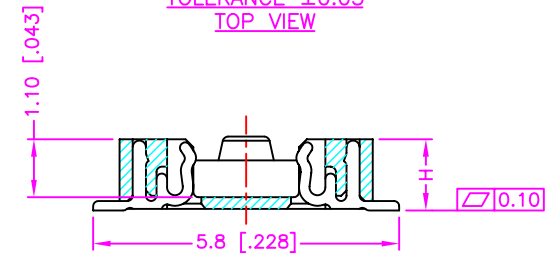
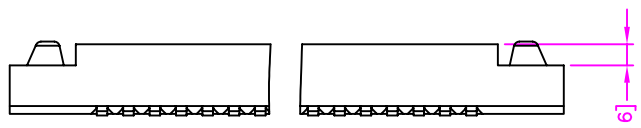

MALE	6091XXX-254	6091XXX-252		2.50 [.098]
FEMALE	6090XXX-254	6090XXX-252	1.85 [.073]	
MALE	6091XXX-253	6091XXX-251		2.00 [.079]
FEMALE	6090XXX-254	6090XXX-252	1.85 [.073]	
MALE	6091XXX-253	6091XXX-251		1.50 [.059]
FEMALE	6090XXX-253	6090XXX-251	1.35 [.053]	
	TUBE PACKAGE	TAPE PACKAGE	H	STACKED HEIGHT

**ORDERING INFORMATION**

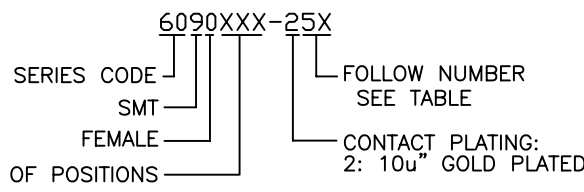

TOLERANCE	
.0=±0.25 [.010]	
.00=±0.15 [.006]	
.000=±0.10 [.004]	
.0000=±	
ANG.=±3°	
UNITS : mm [inch]	
SCALE 1:1	SIZE A4

DRAWER	Nick
CHECK	Katherlin
APP'D	LJON
PRODUCT SPEC.	
SHEET	1 OF 1
REV.	H

**Astron**  
ASTRON TECHNOLOGY CORP.  
NAME  
B TO B 0.5PH SMT FEMALE  
DRAW NO.  
R6090XXX-251(52,53,54)