

REV.	DESCRIPTION	DATE
—	RELEASE	Sep. 6, 2001
1	DRAW MODIFY	Apr. 15, 2002
2	DRAW MODIFY	Jun. 27, 2002
3	DRAW MODIFY	Feb. 12, 2003

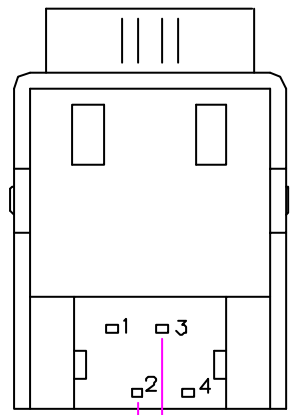

0.80 [.031] TYP.

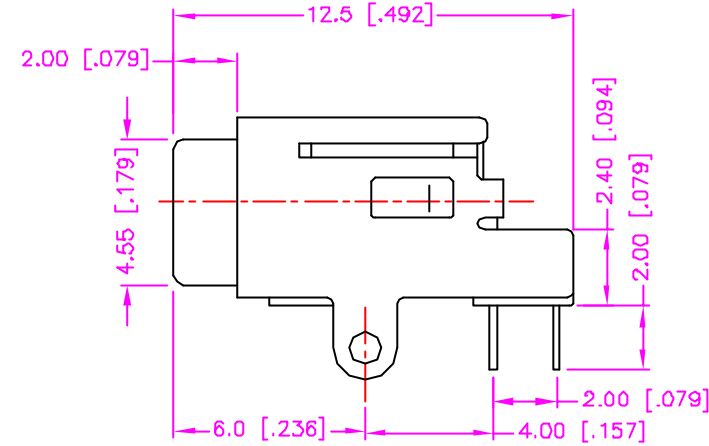
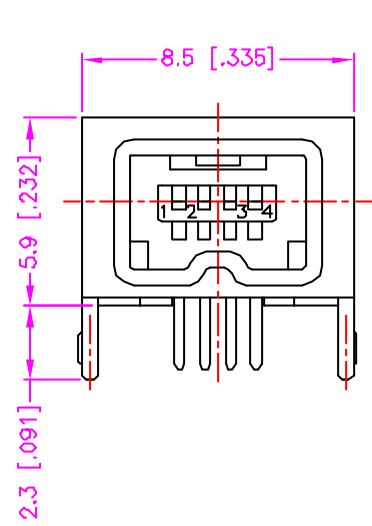
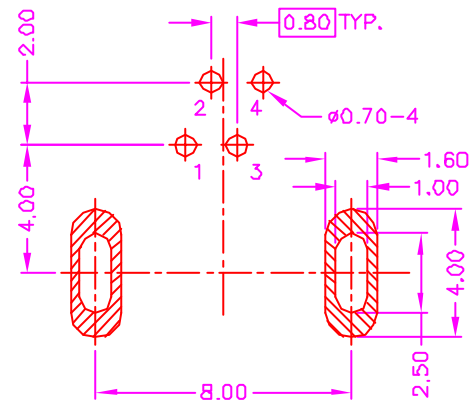

RECOMMEND P.C.B. LAYOUT
TOP VIEW

MATERIALS

1. HOUSING : THERMOPLASTIC (UL 94V-0), BLACK.
2. TERMINAL : PHOSPHOR BRONZE. (t=0.20mm)
3. FRONT SHELL : STEEL, NICKEL PLATING.
4. REAR SHELL : COPPER ALLOY, NICKEL PLATING.

SPECIFICATION

1. CURRENT RATING : 0.5 AMP. MAX.
2. DIELECTRIC WITHSTANDING VOLTAGE : 100V AC R.M.S. FOR ONE MINUTE.
3. INSULATION RESISTANCE : 100M OHMS MIN. AT 100V DC.
4. CONTACT RESISTANCE : 50m OHMS MAX.
5. OPERATING TEMPERATURE : -25°C TO +85°C.
6. DURABILITY : 500 CYCLES.

ORDER INFORMATION :

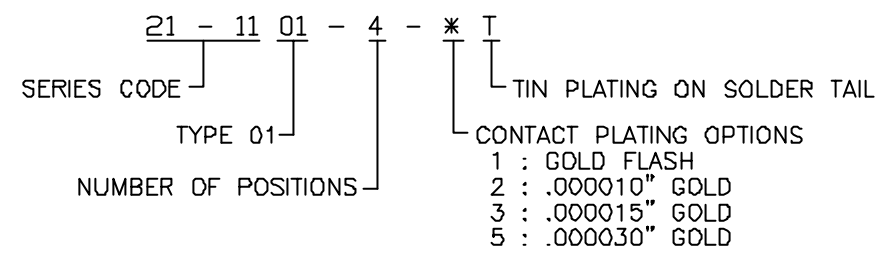

TOLERANCE .0=±0.30 [.012] .00=±0.20 [.008] .000=±.XXX .0000=±. ANG.=±3°	DRAWER <i>PUS</i> CHECK <i>LYON</i> APP'D <i>Katharina</i>	Astron ASTRON TECHNOLOGY CORP. NAME MINI 1394 P.C.B. MOUNT, RIGHT ANGLE METAL SHIELD, FEMALE
UNITS : mm [inch] SCALE NONE SIZE A4 SHEET 1 OF 1 REV. D	PRODUCT SPEC. DRAW NO. C621-1101	