

REV.	DESCRIPTION	DATE
A	RELEASE	Jan. 08, 2004
B		
C		

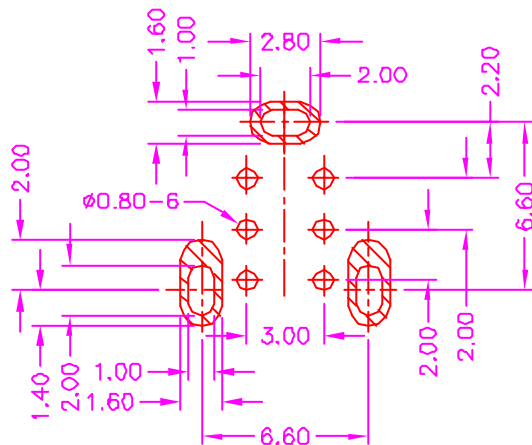
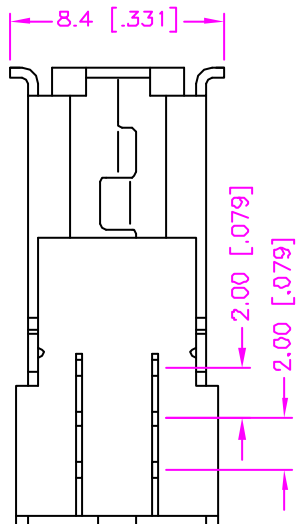
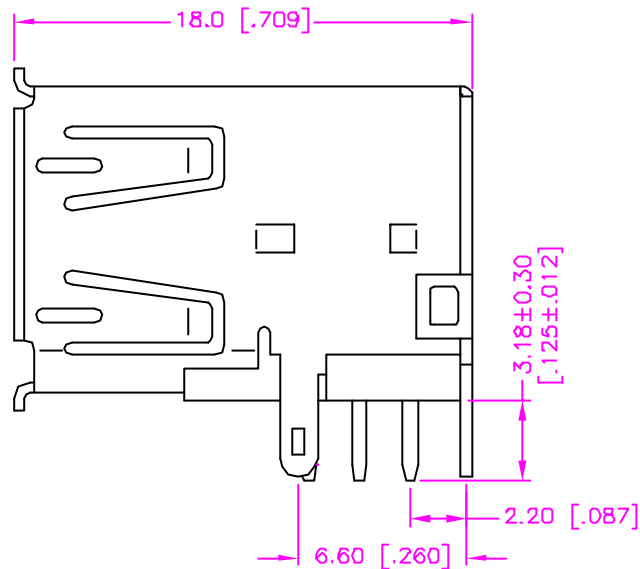
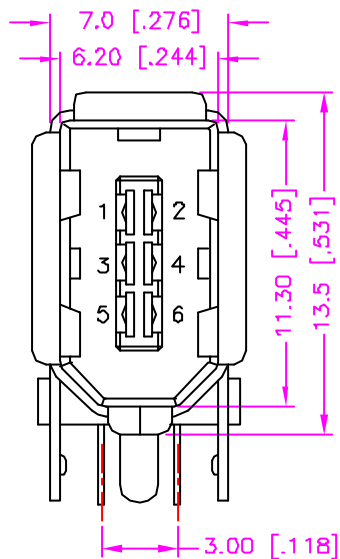

**RECOMMEND P.C.B. LAYOUT  
TOP VIEW**

### MATERIALS

1. HOUSING : POLYESTER (UL 94V-0), BLACK.
2. TERMINAL : COPPER ALLOY. (t=0.25mm)
3. SHELL : COPPER ALLOY, NICKEL PLATING.

### SPECIFICATION

1. CURRENT RATING : 1 AMP. MAX.
2. DIELECTRIC WITHSTANDING VOLTAGE : 500V AC R.M.S. FOR ONE MINUTE.
3. INSULATION RESISTANCE : 1000M OHMS MIN. AT 500V DC.
4. CONTACT RESISTANCE : 30m OHMS MAX.
5. OPERATING TEMPERATURE : -55°C TO +105°C
6. DURABILITY : 1500 CYCLES.

### ORDER INFORMATION :

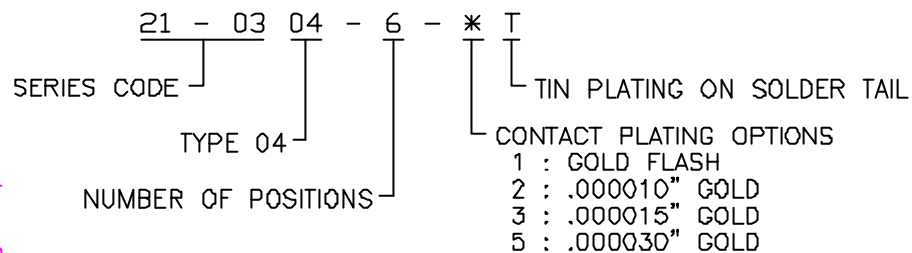

SERIES CODE 21 - 03 04 - 6 - \* T  
 TYPE 04  
 NUMBER OF POSITIONS 6  
 TIN PLATING ON SOLDER TAIL  
 CONTACT PLATING OPTIONS  
 1 : GOLD FLASH  
 2 : .000010" GOLD  
 3 : .000015" GOLD  
 5 : .000030" GOLD

TOLERANCE .0=±0.30 [.012] .00=±0.25 [.010] .000=±.XXX .0000=±. ANG.=±3°	DRAWER PUS	<b>Astron</b> ASTRON TECHNOLOGY CORP. IEEE 1394 CONNECTOR P.C.B. MOUNT, UPRIGHT TYPE METAL SHIELD, FEMALE
	CHECK Katherine	
	APP'D LTON	NAME
UNITS : mm [inch]	PRODUCT SPEC. —	DRAW NO. C621-0303
SCALE NONE	SIZE A4	SHEET 1 OF 1
	REV. A	10004