

REV.	DESCRIPTION	DATE
—	RELEASE	Jul. 25, 2002
1	DRAW MODIFY	Mar. 03, 2003
2		

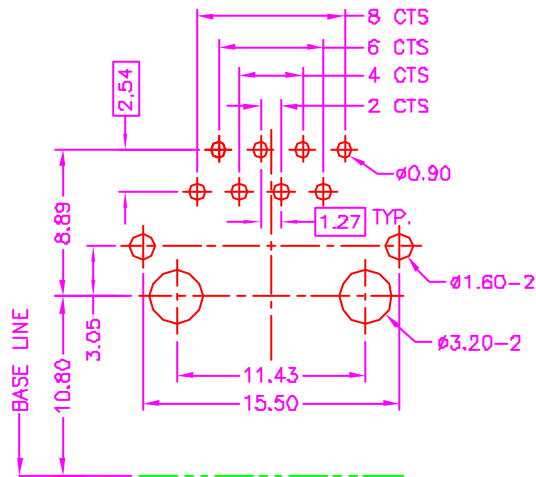
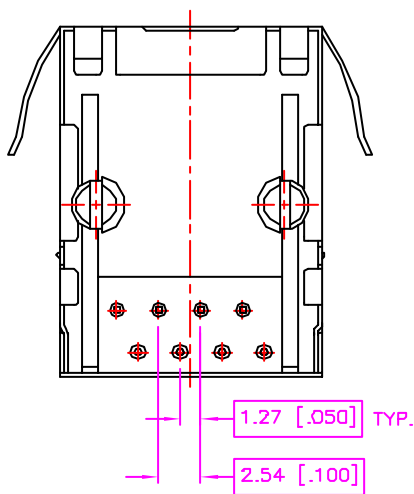
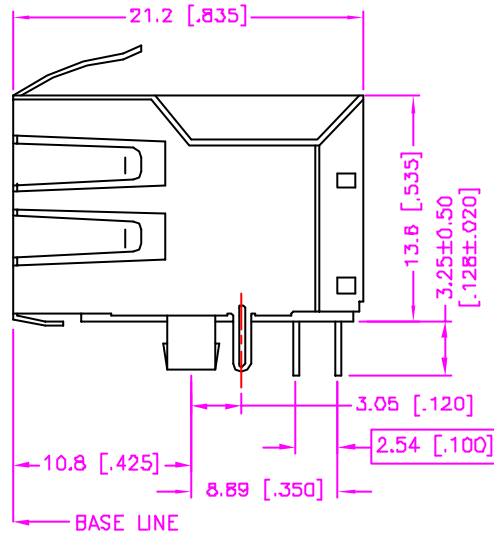
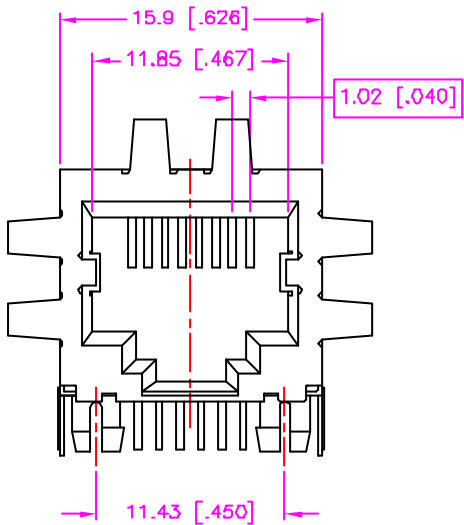

RECOMMEND P.C.B. LAYOUT
TOP VIEW

MATERIALS

1. HOUSING : POLYESTER (UL 94V-0), BLACK.
2. TERMINAL : $\phi 0.45\text{mm}$ PHOSPHOR BRONZE.
3. SHIELD : COPPER ALLOY, NICKEL PLATING. ($t=0.25\text{mm}$)

SPECIFICATION

1. CURRENT RATING : 1.5 AMP. MAX.
2. DIELECTRIC WITHSTANDING VOLTAGE : 1000V AC R.M.S. FOR ONE MINUTE.
3. INSULATION RESISTANCE : 500M OHMS MIN. AT 500V DC.
4. CONTACT RESISTANCE : 30m OHMS MAX.
5. OPERATING TEMPERATURE : -40°C TO $+70^{\circ}\text{C}$.
6. DURABILITY : 750 CYCLES.

ORDER INFORMATION :

17 - 04 01 4 - ** - * G

SERIES CODE | TYPE 01 | CONTACT PLATING OPTIONS
 1 : GOLD FLASH
 2 : .000010" GOLD
 3 : .000015" GOLD
 5 : .000030" GOLD

WITH -3.05mm SHIELD TAB | POSITION & CONTACT
 B2 : 8P2C
 B4 : 8P4C
 B6 : 8P6C
 B8 : 8P8C

GOLD PLATING ON SOLDER TAIL

TOLERANCE .0=±.30 [.012] .00=±.20 [.008] .000=±.XXX .0000=±. ANG.=±3°	DRAWER <i>Katherlin</i> CHECK <i>JFON</i> APP'D <i>JUB</i>	Astron ASTRON TECHNOLOGY CORP. NAME MODULAR JACK SIDE ENTRY, METAL SHIELD WITH SPRING
 UNITS : mm [inch] SCALE NONE SIZE A4 SHEET 1 OF 1 REV. B	PRODUCT SPEC. — 509-0042 DRAW NO. C564-0402	
		DRAW NO. C564-0402 08015