

| REV. | DESCRIPTION | DATE |
|------|-------------|---------------|
| — | RELEASE | Sep. 27, 2000 |
| 1 | P/N MODIFY | Jun. 1, 2001 |
| 2 | | |

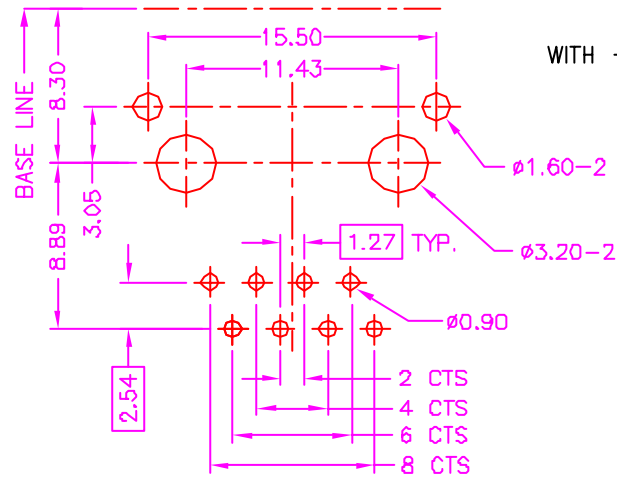
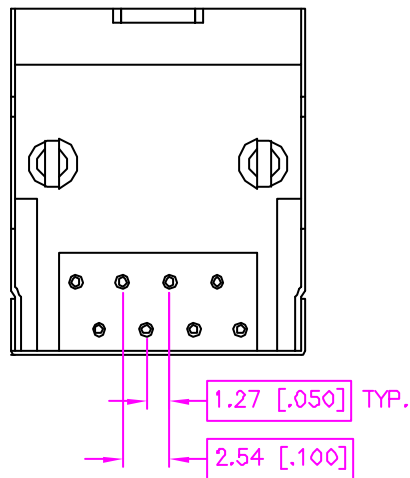
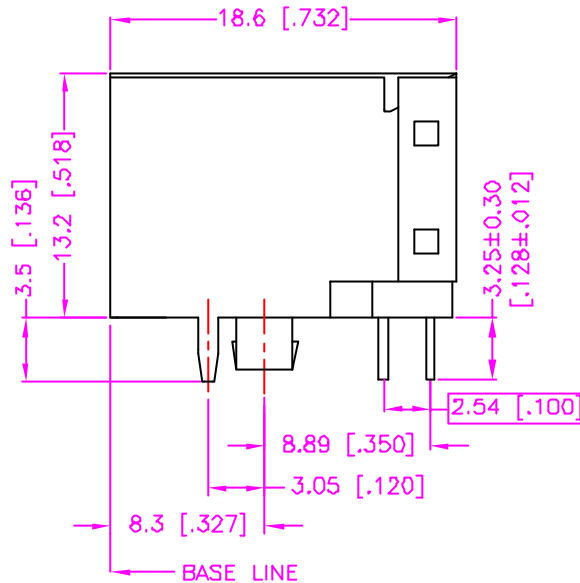
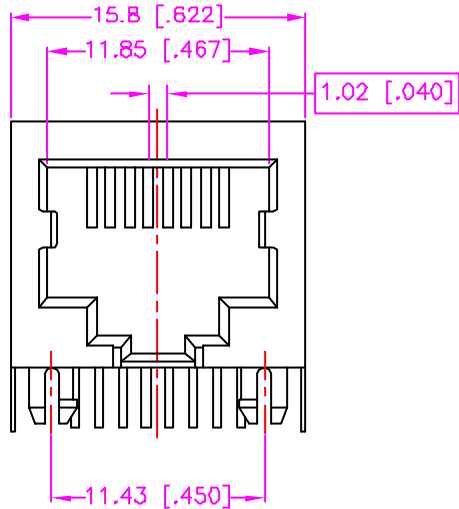

RECOMMEND P.C.B. LAYOUT
BOTTOM VIEW

MATERIALS

- HOUSING : P.B.T. (UL 94V-0), BLACK.
- TERMINAL : $\phi 0.45$ mm PHOSPHOR BRONZE.
- SHIELD : COPPER ALLOY, NICKEL PLATING. ($t=0.25$ mm)

SPECIFICATION

- CURRENT RATING : 1.5 AMP. MAX.
- DIELECTRIC WITHSTANDING VOLTAGE : 1000V AC R.M.S. FOR ONE MINUTE.
- INSULATION RESISTANCE : 500M OHMS MIN. AT 500V DC.
- CONTACT RESISTANCE : 30m OHMS MAX.
- OPERATING TEMPERATURE : -40°C TO $+70^{\circ}\text{C}$.
- DURABILITY : 750 CYCLES.

ORDER INFORMATION :

17 - 03 03 1 - ** - * G

SERIES CODE | TYPE 03 | POSITION & CONTACT

WITH +3.05mm SHIELD TAB

GOLD PLATING ON SOLDER TAIL

CONTACT PLATING OPTIONS

- 1 : GOLD FLASH
- 2 : .000010" GOLD
- 3 : .000015" GOLD
- 5 : .000030" GOLD

82 : 8P2C
84 : 8P4C
86 : 8P6C
88 : 8P8C

| | | |
|--|--|--|
| TOLERANCE .0±.30 [.012] .00±.20 [.008] .000±.XXX .0000±. ANG.=±3° | DRAWER <i>sub</i> CHECK <i>Katharin</i> APP'D <i>WJ&Y</i> | ASTRON TECHNOLOGY CORP. NAME MODULAR JACK SIDE ENTRY, METAL SHIELD |
| UNITS : mm [inch] | PRODUCT SPEC. — | |
| SCALE NDNE | SIZE A4 | DRAW NO. C564-0304 |
| SHEET 1 OF 1 | REV. B | D8015 |