

REV.	DESCRIPTION	DATE
—	RELEASE	Jun. 01, 2002
1		
2		

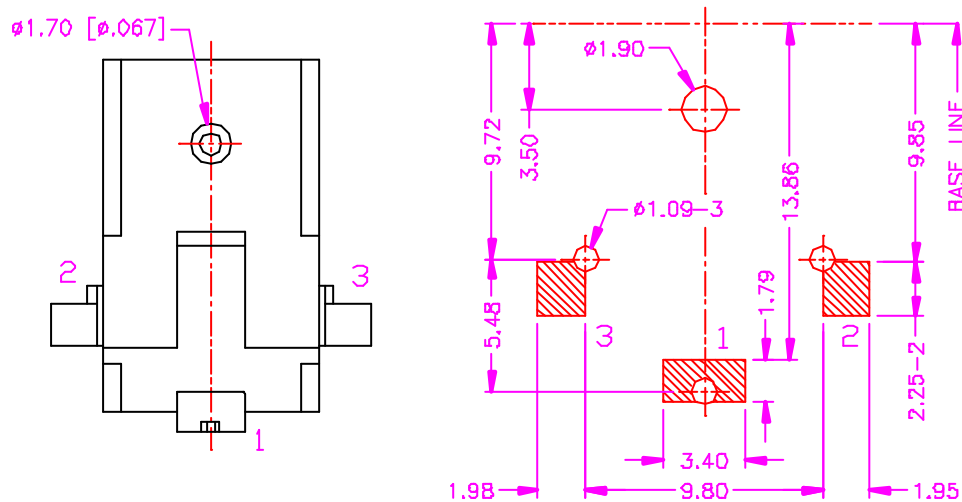

RECOMMEND P.C.B LAYOUT  
TOP VIEW

**SCHEMATIC**

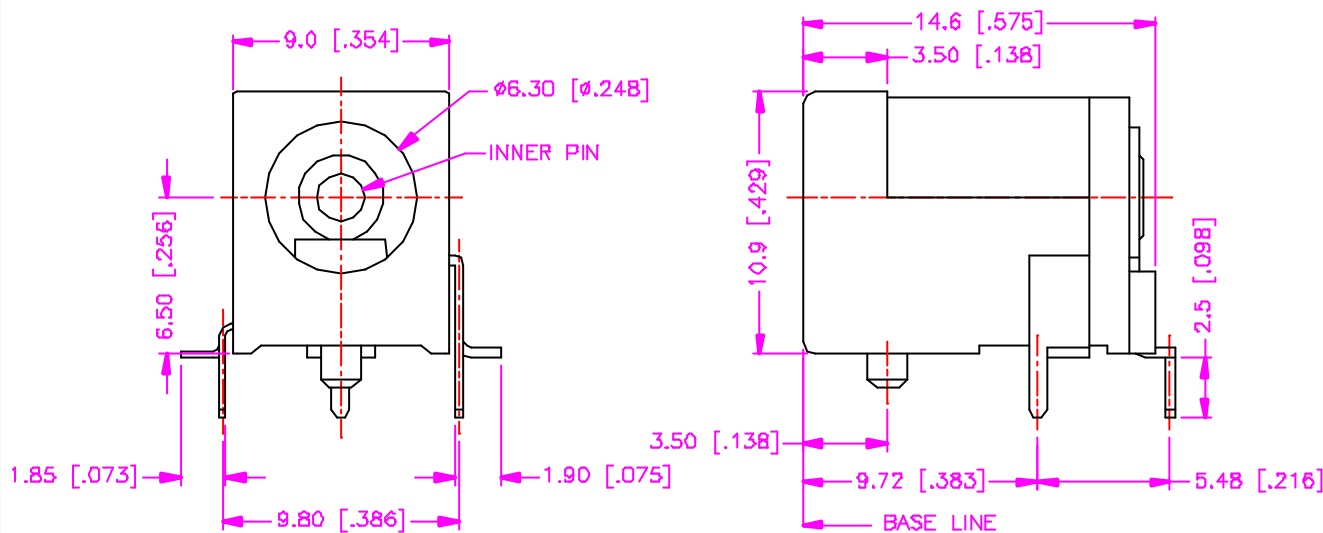
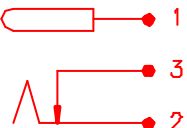

**MATERIALS**

1. HOUSING : HI.-TEMP. PLASTIC (UL 94V-0), BLACK.
2. TERMINAL : COPPER ALLOY, SILVER PLATING.
3. CENTER PIN : BRASS, NICKEL PLATING.

**SPECIFICATION**

1. CURRENT RATING : 2.5 AMP. MAX.
2. DIELECTRIC WITHSTANDING VOLTAGE : 500V AC R.M.S. FOR ONE MINUTE.
3. INSULATION RESISTANCE : 100M OHMS MIN. AT 500V DC
4. CONTACT RESISTANCE : 50m OHMS MAX.
5. OPERATING TEMPERATURE : -25°C TO +70°C.
6. DURABILITY : 5000 CYCLES.
7. MATING FORCE : 0.3 ~ 3.0kgs.
8. UNMATING FORCE : 0.3 ~ 3.0kgs.
9. MAX. PROCESSING TEMPERATURE : 230°C FOR 30 ~ 60 SECONDS.

**ORDER INFORMATION**

15 - 02 05 \*

SERIES CODE — INNER PIN DIA. OPTIONS  
TYPE Q5 — 2 :  $\phi$ 2.50mm  
4 :  $\phi$ 2.00mm

TOLERANCE .0=±.30 [.012] .00=±.20 [.008] .000=±.XXX .0000=±. ANG.=±3°		DRAWER <i>ms</i> CHECK <i>Katherine</i> APP'D <i>WJPG/2Y</i>		<b>Astron</b> ASTRON TECHNOLOGY CORP. NAME DC POWER JACK P.C.B. MOUNT, SMT TYPE FEMALE		
UNITS : mm [inch]		PRODUCT SPEC. — 516-0009				DRAW NO. C522-0203
SCALE NONE	SIZE A4	SHEET 1 OF 1	REV. A	08005		