

REV.	DESCRIPTION	DATE
—	RELEASE	Jul. 23, 2001
1		
2		

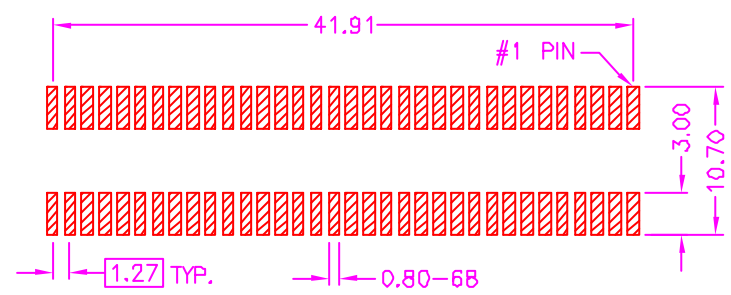
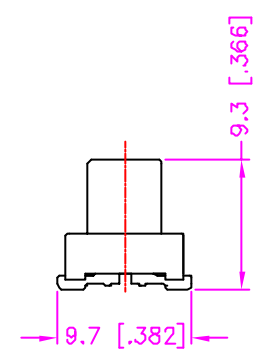
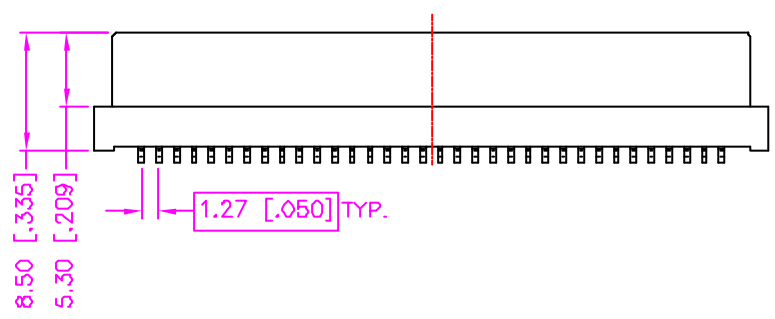
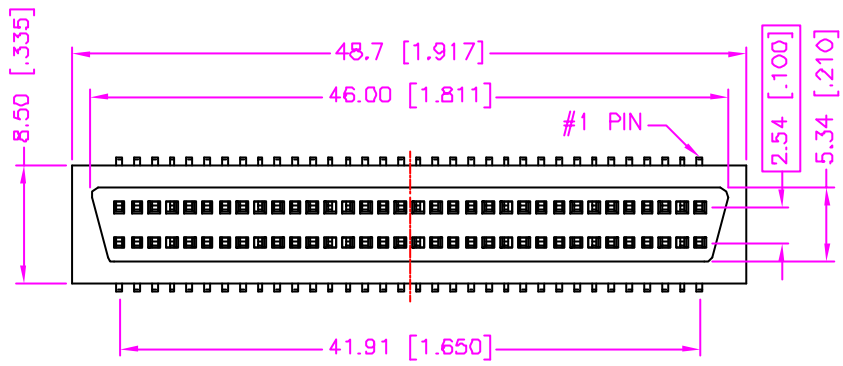

RECOMMEND P.C.B. LAYOUT  
TOP VIEW

### MATERIALS

- HOUSING : HI.-TEMP. PLASTIC (UL 94V-0), BLACK.
- TERMINAL : COPPER ALLOY. (t=0.40mm)

### SPECIFICATION

- CURRENT RATING : 1 AMP. MAX.
- DIELECTRIC WITHSTANDING VOLTAGE : 500V AC R.M.S. FOR ONE MINUTE.
- INSULATION RESISTANCE : 1000M OHMS MIN. AT 500V DC.
- CONTACT RESISTANCE : 30m OHMS MAX.
- OPERATING TEMPERATURE : -55°C TO +105°C.
- MAX. PROCESSING TEMP. : 230°C FOR 30 ~ 60 SECONDS.

### ORDER INFORMATION :

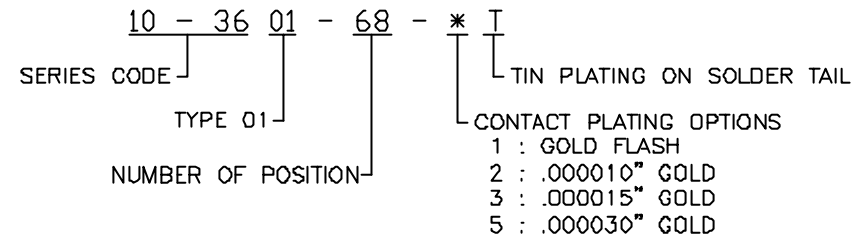

TOLERANCE .0=±.30 [.012] .00=±.20 [.008] .000=±.XXX .0000=±. ANG.=±3°		DRAWER <i>pu8</i>		 ASTRON TECHNOLOGY CORP.
UNITS : mm [Inch]		CHECK <i>Kathelin</i>		
SCALE NONE		APP'D <i>ASST</i>		NAME SCSI SERIES 1.27mm PITCH, P.C.B. MOUNT ALL PLASTIC, FEMALE
SIZE A4		PRODUCT SPEC. —		DRAW NO. C455-0001
SHEET 1 OF 1		REV. A		1001B