

| REV. | DESCRIPTION | DATE |
|------|-------------|--------------|
| — | RELEASE | Jan. 9, 2001 |
| 1 | | |
| 2 | | |

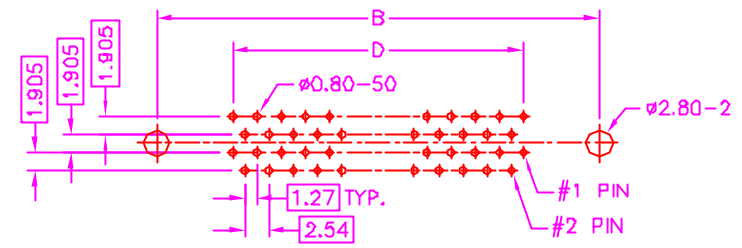

RECOMMEND P.C.B. LAYOUT (50 PINS)
BOTTOM VIEW

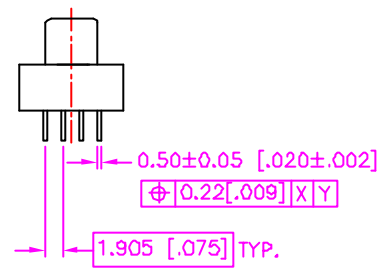
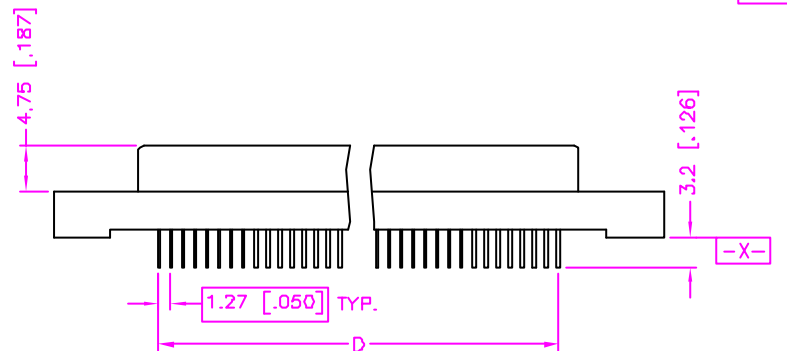
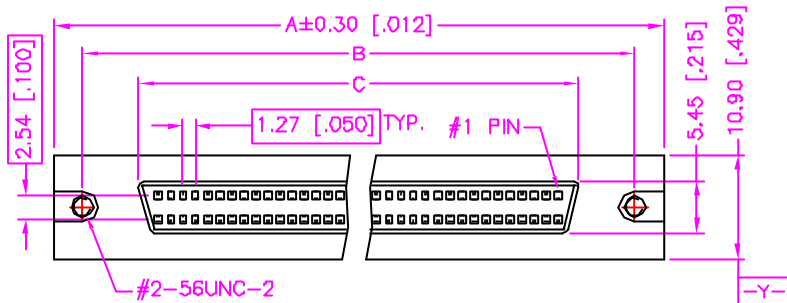
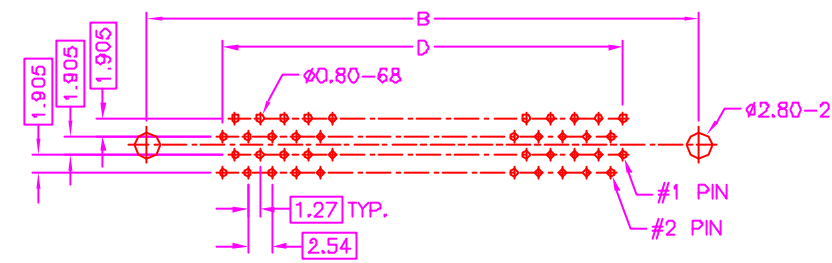

RECOMMEND P.C.B. LAYOUT (68 PINS)
BOTTOM VIEW

MATERIALS

1. HOUSING : P.B.T. (UL 94V-0), BLACK.
2. TERMINAL : PHOSPHOR BRONZE. (t=0.30mm)
3. SHELL : ZINC ALLOY, NICKEL PLATING.

SPECIFICATION

1. CURRENT RATING : 1 AMP. MAX.
2. DIELECTRIC WITHSTANDING VOLTAGE : 500V AC R.M.S. FOR ONE MINUTE.
3. INSULATION RESISTANCE : 500M OHMS MIN. AT 500V DC.
4. CONTACT RESISTANCE : 35m OHMS MAX.
5. OPERATING TEMPERATURE : -55°C TO +105°C.
6. DURABILITY : 500 CYCLES.

ORDER INFORMATION :

10 - 05 2 - ** - * T

SERIES CODE — P.C.B. LAYOUT STYLE — NUMBER OF POSITION — TIN PLATING ON SOLDER TAIL — CONTACT PLATING OPTIONS

2 : STYLE 2

1 : GOLD FLASH
2 : .000010" GOLD
3 : .000015" GOLD
5 : .000030" GOLD

| Number Of Position | DIMENSIONS | | | |
|-----------------------|--------------|--------------|--------------|--------------|
| | A | B | C | D |
| 50 | 52.45[2.065] | 46.48[1.830] | 34.70[1.366] | 30.48[1.200] |
| 68 | 63.88[2.515] | 57.91[2.280] | 46.13[1.816] | 41.91[1.650] |

| | | | |
|--|--|---------------------------|---|
| TOLERANCE .0=±.30 [.012] .00=±.20 [.008] .000=±.XXX .0000=±. ANG.=±3° | | DRAWER <i>Katharin</i> | Astron ASTRON TECHNOLOGY CORP. |
| UNITS : mm [inch] | | CHECK <i>Sue</i> | |
| SCALE NONE | | APP'D <i>Windy</i> | NAME SCSI SERIES |
| SIZE A4 | | PRODUCT SPEC. — | PIN TYPE, STYLE 2, FEMALE, VERTICAL METAL SHELL, WITHOUT LATCH |
| SHEET 1 OF 1 | | REV. A | DRAW NO. C451-0016 |
| REV. A | | 18003 | |