

| REV. | DESCRIPTION | DATE |
|------|-------------|---------------|
| — | RELEASE | Aug. 10, 2001 |
| 1 | | |
| 2 | | |

$$A = \{ \text{TOTAL NO. OF PINS} - 1 \} \times 1.00 + 4.80 \pm 0.30$$

$$(\text{TOTAL NO. OF PINS} - 1) \times 0.039 + 1.89 \pm 0.12$$

$$B = \{ \text{TOTAL NO. OF PINS} - 1 \} \times 1.00 + 2.20$$

$$(\text{TOTAL NO. OF PINS} - 1) \times 0.039 + 1.087$$

$$C = \{ \text{TOTAL NO. OF PINS} - 1 \} \times 1.00$$

$$(\text{TOTAL NO. OF PINS} - 1) \times 0.039$$

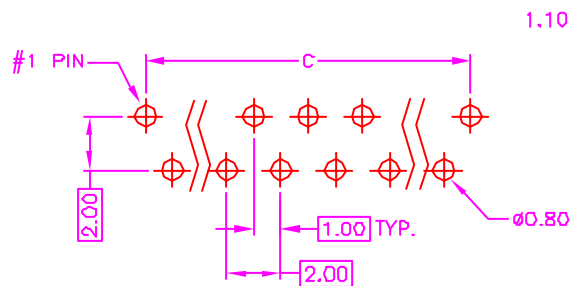
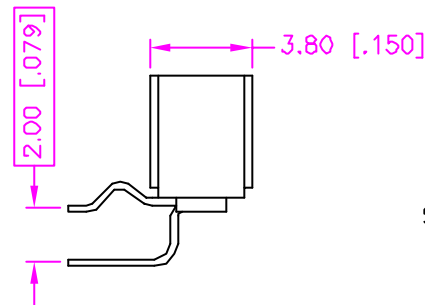
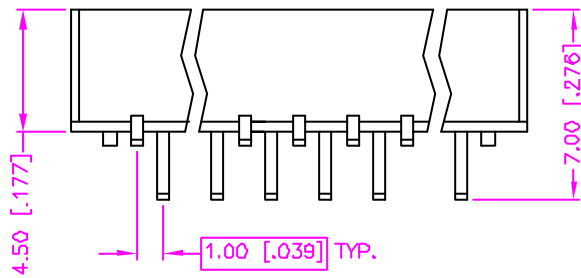
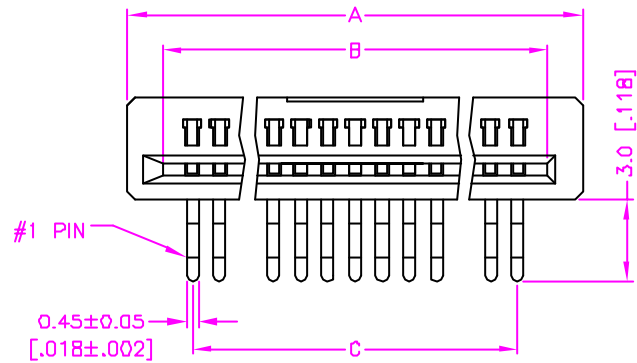

RECOMMEND P.C.B. LAYOUT
BOTTOM VIEW

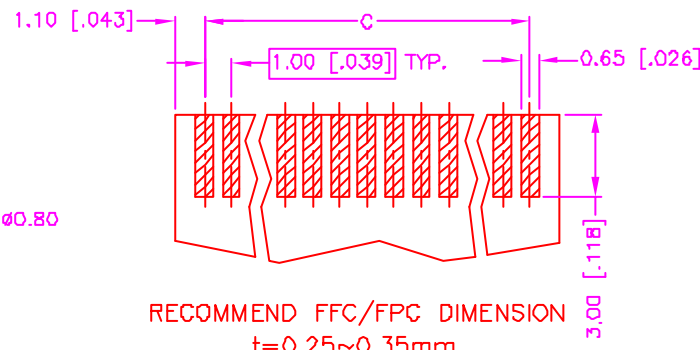

RECOMMEND FFC/FPC DIMENSION
t=0.25~0.35mm

MATERIALS

- HOUSING : THERMOPLASTIC (UL 94V-0).
- TERMINAL : PHOSPHOR BRONZE, TIN PLATING. (t=0.25mm)

SPECIFICATION

- CURRENT RATING : 0.5 AMP. MAX.
- DIELECTRIC WITHSTANDING VOLTAGE : 500V AC R.M.S. FOR ONE MINUTE.
- INSULATION RESISTANCE : 500M OHMS MIN. AT 250V DC.
- CONTACT RESISTANCE : 30m OHMS MAX.
- OPERATING TEMPERATURE : -40°C TO +85°C.

ORDER INFORMATION :

55 - 2302 1 - ** W - T

SERIES CODE | TOP CONTACT | NUMBER OF POSITIONS 04 ~ 34 PINS | TIN PLATING ON TERMINAL | WHITE IN HOUSING COLOR

| | | |
|--|---------------------------|--|
| TOLERANCE .0=±0.30 [.012] .00=±0.20 [.008] .000=±.XXX .0000=±. ANG.=±3° | DRAWER <i>MUS</i> | Astron ASTRON TECHNOLOGY CORP. |
| | CHECK <i>Katherlin</i> | |
| UNITS : mm [inch] | APP'D <i>ALBT</i> | 1.00mm PITCH, P.C.B. MOUNT |
| | PRODUCT SPEC. — | R/A, NON-ZIF, KINK PIN |
| SCALE NONE | SIZE A4 | DRAW NO. C355-2301 |
| SHEET 1 OF 1 | REV. A | 10015 |