

REV.	DESCRIPTION	DATE
—	RELEASE	Jun. 11. 2002
1		
2		

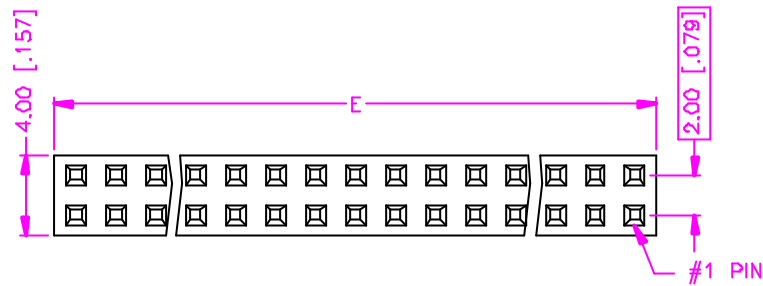

$$E = (\text{NO. OF POSITION PER ROW}) \times 2.00 + 0.20 \pm 0.40$$

$$(\text{NO. OF POSITION PER ROW}) \times 0.079 + 0.008 \pm 0.016$$

$$F = (\text{NO. OF POSITION PER ROW} - 1) \times 2.00$$

$$(\text{NO. OF POSITION PER ROW} - 1) \times 0.079$$

### MATERIALS

1. HOUSING : POLYAMIDE (UL 94V-0), BLACK.
2. TERMINAL : PHOSPHOR BRONZE. (t=0.50mm)

### SPECIFICATION

1. CURRENT RATING : 1 AMP. MAX.
2. DIELECTRIC WITHSTANDING VOLTAGE : 800V AC R.M.S. FOR ONE MINUTE.
3. INSULATION RESISTANCE : 5000M OHMS MIN. AT 500V DC.
4. CONTACT RESISTANCE : 30m OHMS MAX.
5. OPERATING TEMPERATURE : -55°C TO +105°C.

### ORDER INFORMATION :

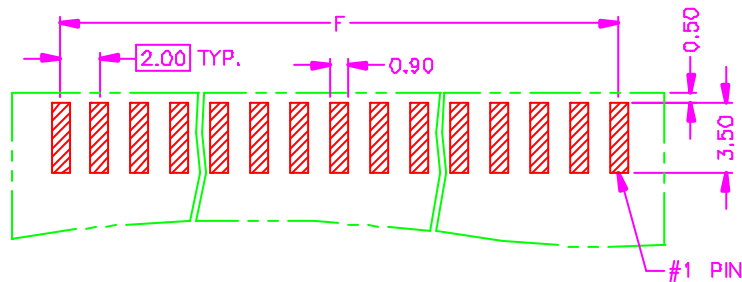
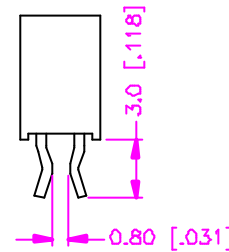
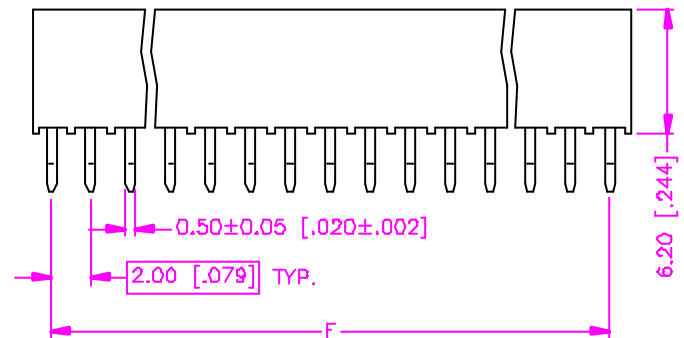
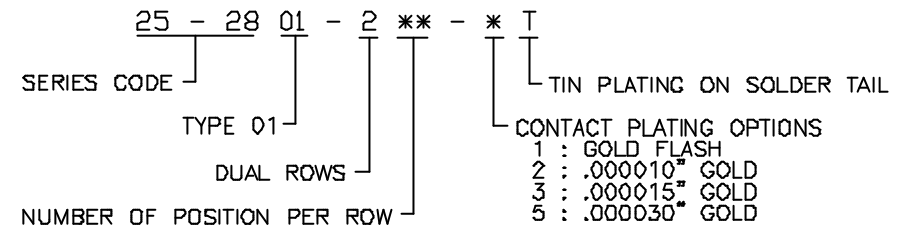

RECOMMEND P.C.B. LAYOUT  
BOTH SIDES

TOLERANCE .0-±0.30 [.012] .00=±0.20 [.008] .000=±.XXX .0000=±. ANG.=±3°		DRAWER <i>MUB</i>	<b>Astron</b> ASTRON TECHNOLOGY CORP.
UNITS : mm [inch]		CHECK <i>Katherlin</i>	
SCALE NONE SIZE A4		APP'D <i>ALBT</i>	NAME POST HEADER RECEPTACLE STRADDLE MOUNT 2.00mm PITCH
SHEET 1 OF 1 REV. A		PRODUCT SPEC. —	DRAW NO. C348-2002
			10018