

REV.	DESCRIPTION	DATE
—	RELEASE	Nov. 15, 2002
1		
2		

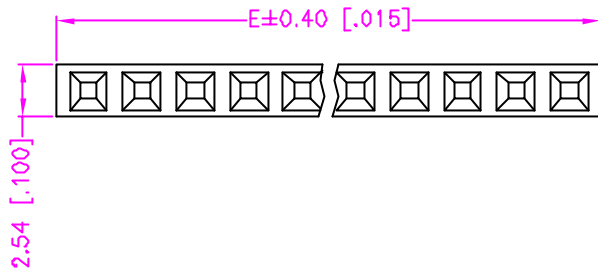

$$E = (\text{NO. OF POSITION PER ROW}) \times 2.54 + 0.50$$

$$(\text{NO. OF POSITION PER ROW}) \times 1.00 + 0.020$$

$$F = (\text{NO. OF POSITION PER ROW} - 1) \times 2.54$$

$$(\text{NO. OF POSITION PER ROW} - 1) \times 1.00$$

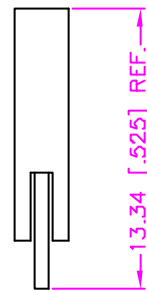
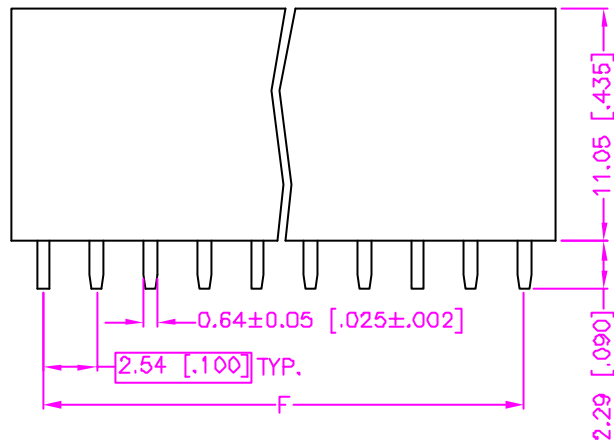

MATERIALS

- HOUSING : POLYESTER (UL 94V-0), BLACK.
- TERMINAL : COPPER ALLOY. (t=0.64mm)

SPECIFICATION

- CURRENT RATING : 3 AMP. MAX.
- DIELECTRIC WITHSTANDING VOLTAGE : 1000V AC R.M.S. FOR ONE MINUTE.
- INSULATION RESISTANCE : 5000M OHMS MIN. AT 1000V DC.
- CONTACT RESISTANCE : 30m OHMS MAX.
- OPERATING TEMPERATURE : -55°C TO +105°C.

ORDER INFORMATION :

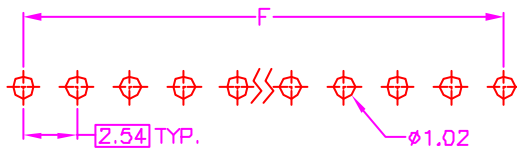
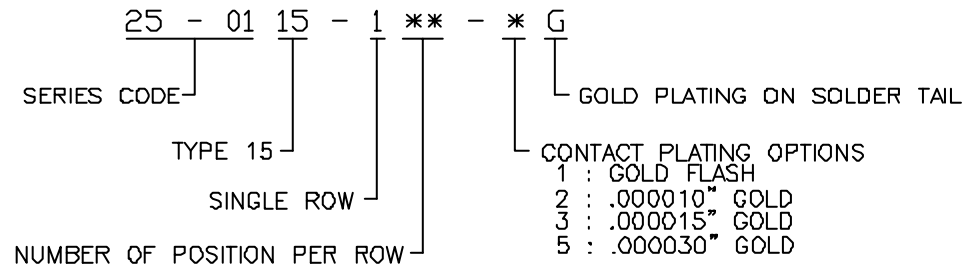

RECOMMEND P.C.B. LAYOUT
TOP VIEW

TOLERANCE .0=±.30 [.012] .00=±.20 [.008] .000=±.XXX .0000=±. ANG.=±3°		DRAWER <i>Katharina</i>		 ASTRON TECHNOLOGY CORP.
 UNITS : mm [inch]		CHECK <i>MS</i>	NAME POST HEADER RECEPTACLE 2.54mm PITCH, P.C.B. MOUNT VERTICAL	
SCALE NONE	SIZE A4	SHEET 1 OF 1	REV. A	DRAW NO. C341-1016
			1001B	