

REV.	DESCRIPTION	DATE
—	RELEASE	JUL 12, 2001
1		
2		

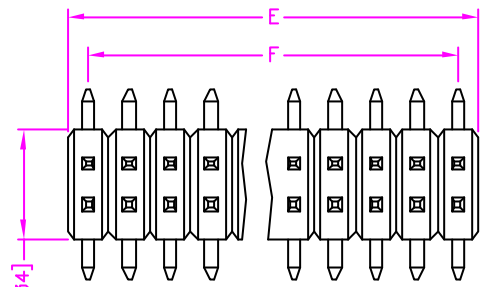

$$E = (\text{NO. OF POSITION PER ROW}) \times 1.27 \pm 0.30$$

$$F = (\text{NO. OF POSITION PER ROW}) \times 0.050 \pm 0.012$$

$$F = (\text{NO. OF POSITION PER ROW} - 1) \times 1.27$$

$$F = (\text{NO. OF POSITION PER ROW} - 1) \times 0.050$$

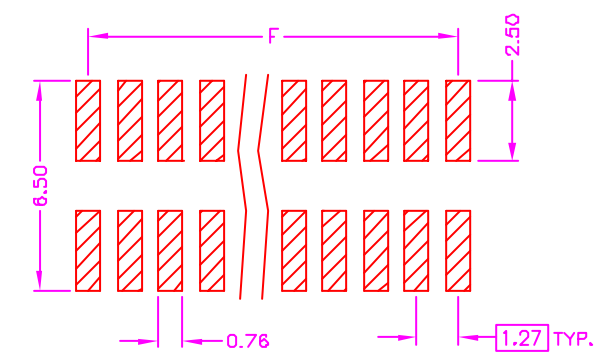
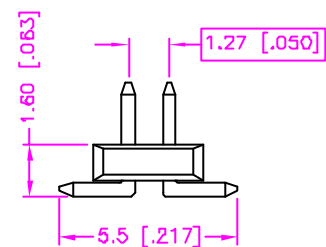
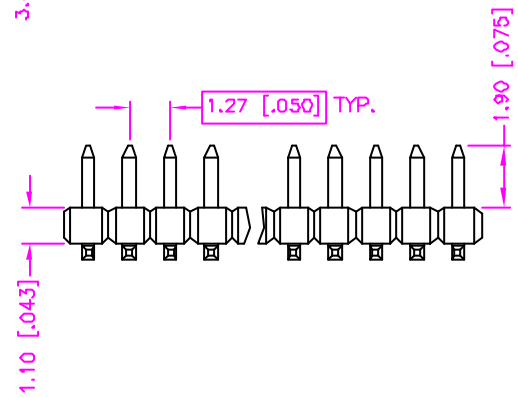

RECOMMEND P.C.B. LAYOUT
BOTTOM VIEW

MATERIALS

- HOUSING : HI.-TEMP. PLASTIC (UL 94V-0), BLACK.
- TERMINAL : S.Q. 0.40mm COPPER ALLOY.

SPECIFICATION

- CURRENT RATING : 1 AMP. MAX.
- DIELECTRIC WITHSTANDING VOLTAGE : 600V AC R.M.S. FOR ONE MINUTE.
- INSULATION RESISTANCE : 5000M OHMS MIN. AT 500V DC.
- OPERATING TEMPERATURE : -55°C TO +105°C.
- MAX. PROCESSING TEMPERATURE : 230°C FOR 30 ~ 60 SECONDS.

ORDER INFORMATION :

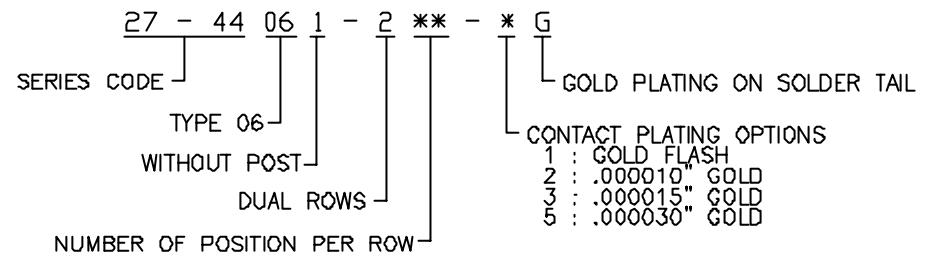

TOLERANCE		DRAWER		Astron
.0=±0.30 [.012]		PUB		
.00=±0.20 [.008]		CHECK		ASTRON TECHNOLOGY CORP.
.000=±.XXX		APP'D		NAME
ANG.=±3°		KATHERLIN		1.27x1.27mm PITCH, P.C.B. MOUNT
PRODUCT SPEC.		WJBY		SMT TYPE
UNITS : mm [inch]		DRAW NO.		C333-4004
SCALE	SIZE	SHEET	REV.	05005
NONE	A4	1 OF 1	A	