

REV.	DESCRIPTION	DATE
—	RELEASE	Jul. 3, 2001
1		
2		

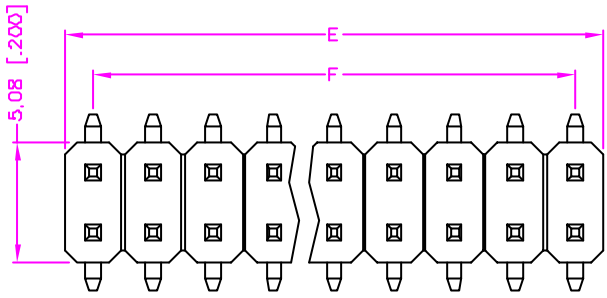

$$E = (\text{NO. OF POSITION PER ROW}) \times 2.54 \pm 0.40$$

$$(\text{NO. OF POSITION PER ROW}) \times 1.00 \pm 0.16$$

$$F = (\text{NO. OF POSITION PER ROW} - 1) \times 2.54$$

$$(\text{NO. OF POSITION PER ROW} - 1) \times 1.00$$

**MATERIALS**

1. HOUSING : HI.-TEMP. PLASTIC (UL 94V-0), BLACK.
2. TERMINAL : S.Q. 0.64mm BRASS.

**SPECIFICATION**

1. CURRENT RATING : 3 AMP. MAX.
2. DIELECTRIC WITHSTANDING VOLTAGE : 1000V AC R.M.S. FOR ONE MINUTE.
3. INSULATION RESISTANCE : 5000M OHMS MIN. AT 100V DC.
4. OPERATING TEMPERATURE : -55°C TO +105°C.
5. MAX. PROCESSING TEMP. : 230°C FOR 30 ~ 60 SECONDS.

**ORDER INFORMATION :**

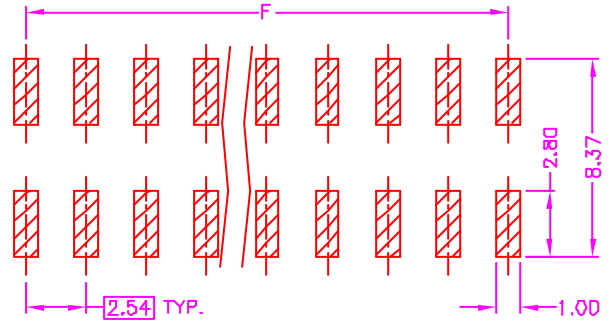
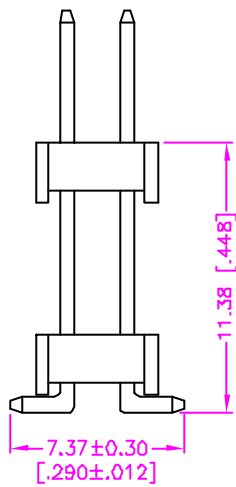
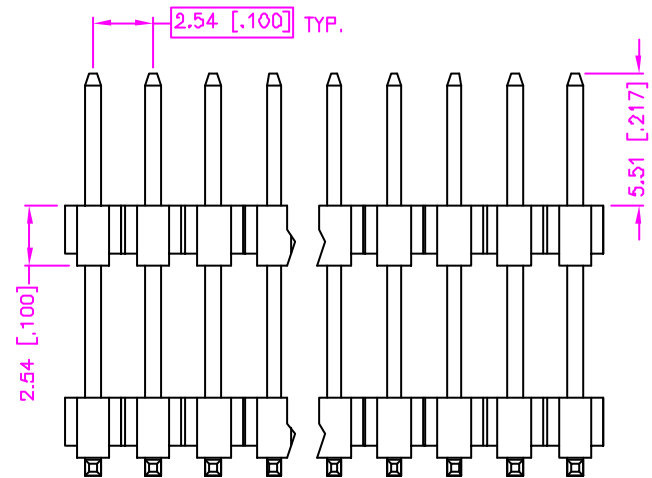
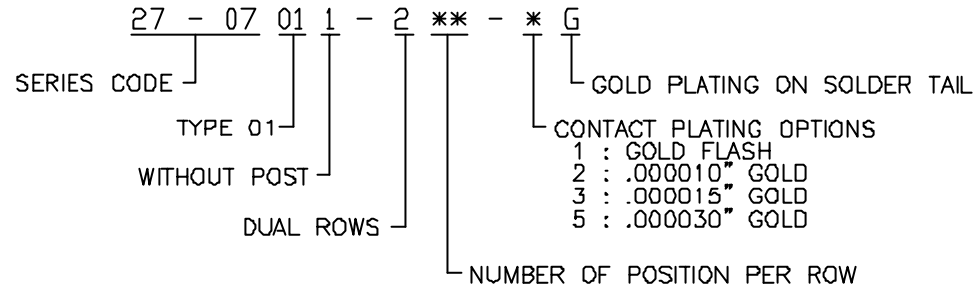

**RECOMMEND P.C.B. LAYOUT  
TOP VIEW**

TOLERANCE		DRAWER	<b>Astron</b>
.0=±0.30 [.012]		<i>SUS</i>	
.00=±0.20 [.008]		CHECK	ASTRON TECHNOLOGY CORP.
.000=±.XXX		APP'D	NAME
.0000=±.		<i>Katherine</i>	POST HEADER
ANG.=±3°		<i>WYBYLY</i>	2.54mm PITCH, P.C.B. MOUNT
UNITS : mm [inch]		PRODUCT SPEC.	SMT ELEVATE
SCALE NONE		SHEET	DRAW NO.
SIZE A4		1 OF 1	C331-7002
		REV.	05005
		A	