

REV.	DESCRIPTION	DATE
—	RELEASE	SEP. 4, 2001
1		
2		

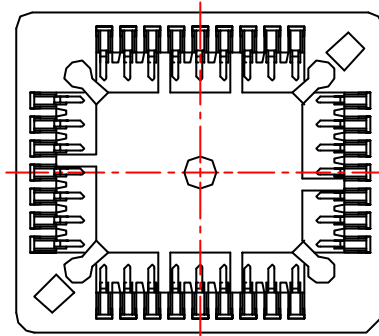
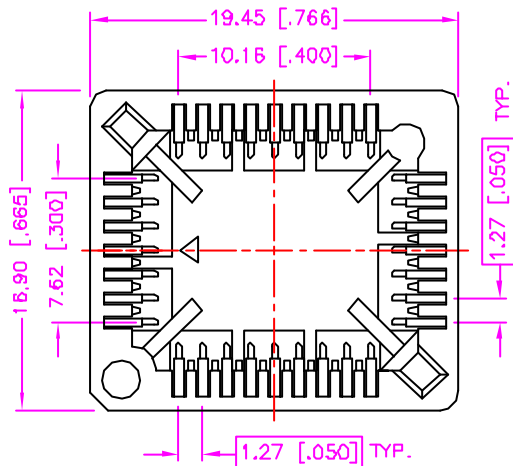

BOTTOM VIEW

**MATERIALS**

1. HOUSING : HI.-TEMP. PLASTIC (UL 94V-0).
2. TERMINAL : PHOSPHOR BRONZE, TIN PLATING.  
(t=0.17mm)

**SPECIFICATION**

1. CURRENT RATING : 1 AMP. MAX.
2. DIELECTRIC WITHSTANDING VOLTAGE :  
600V AC R.M.S. FOR ONE MINUTE.
3. INSULATION RESISTANCE : 1000M OHMS MIN.  
AT 500V DC
4. CONTACT RESISTANCE : 30m OHMS MAX.
5. OPERATING TEMPERATURE : -55°C TO +105°C.
6. CAPACITANCE : 1PF.
7. MAX. PROCESSING TEMP. :  
230°C FOR 30~60 SECONDS.

**ORDER INFORMATION**

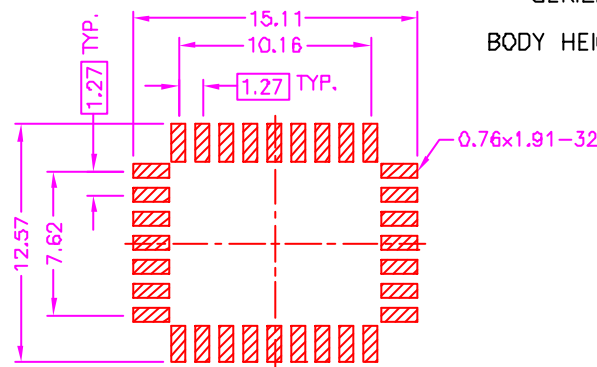
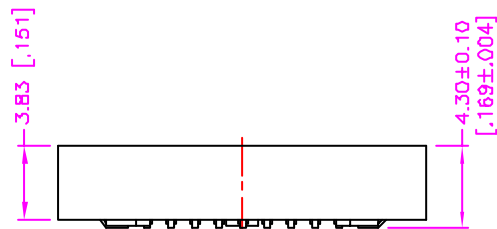
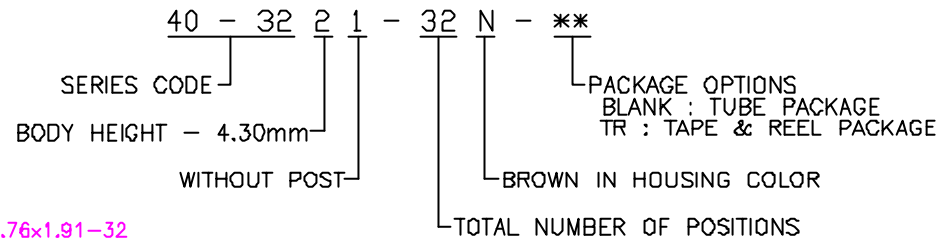

RECOMMEND P.C.B. LAYOUT  
TOP VIEW

TOLERANCE .0=±.30 [.012] .00=±.20 [.008] .000=±.XXX .0000=±. ANG.=±3°	DRAWER <i>Katherlin</i> CHECK <i>JUS</i> APP'D <i>ASL</i>	<b>Astron</b> ASTRON TECHNOLOGY CORP. NAME PLCC SOCKET 1.27mm PITCH, P.C.B. MOUNT SMT TYPE
UNITS : mm [inch]	PRODUCT SPEC. —	
SCALE NONE	SIZE A4	SHEET 1 OF 1
	REV. A	D9008/10018