

REV.	DESCRIPTION	DATE
—	RELEASE	Oct. 7, 2000
1	DRAW MODIFY	Jan. 27, 2003
2		

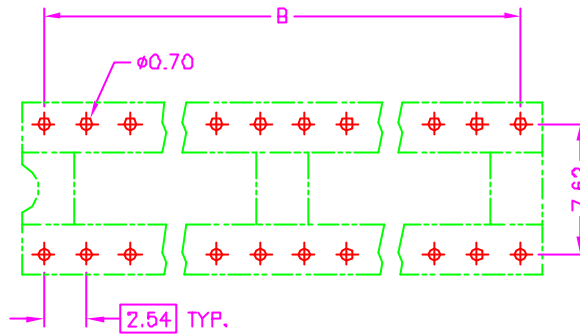
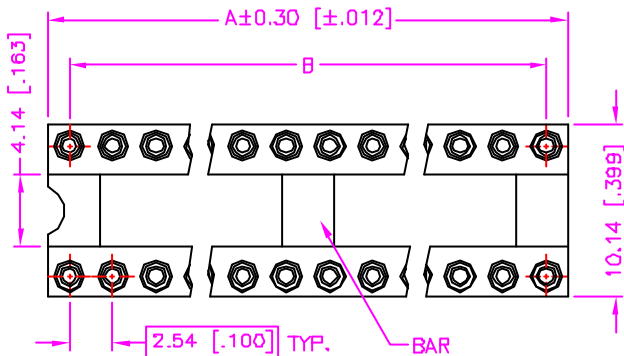

RECOMMEND P.C.B. LAYOUT
TOP VIEW

MATERIALS

1. HOUSING : POLYESTER (UL 94V-0), BLACK.
2. CONTACT : BERYLLIUM COPPER, GOLD PLATING.
3. SLEEVE : BRASS, TIN PLATING.

SPECIFICATION

1. CURRENT RATING : SIGNAL APPLICATION ONLY.
2. DIELECTRIC WITHSTANDING VOLTAGE : 1000V AC R.M.S. FOR ONE MINUTE.
3. INSULATION RESISTANCE : 5000M OHMS MIN. AT 1000V DC.
4. CONTACT RESISTANCE : 30m OHMS MAX.
5. OPERATING TEMPERATURE : -55°C TO +105°C.

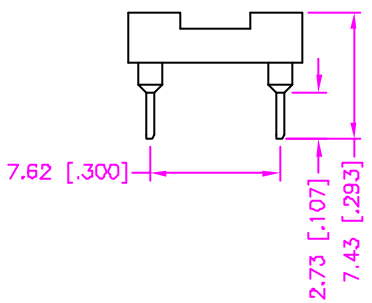
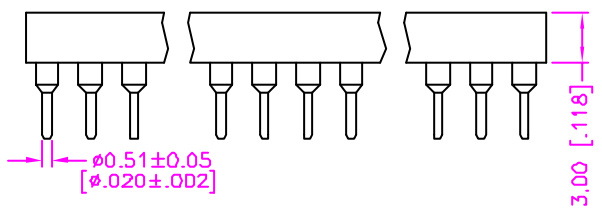

ORDER INFORMATION :

40 - 02 01 3 - **
 SERIES CODE TOTAL NUMBER OF POSITIONS
 TYPE 01 ROWS SPACING 7.62mm (0.3")

NUMBER OF POSITIONS	DIMENSION		BAR OPTIONS	
	A	B	WITH BAR	W/D BAR
6	7.62[.300]	5.08[.200]		○
8	10.14[.399]	7.62[.300]		○
10	12.68[.499]	10.16[.400]		○
14	17.76[.699]	15.24[.600]		○
16	20.30[.799]	17.78[.700]		○
18	22.84[.899]	20.32[.800]	○	
20	25.38[.999]	22.86[.900]	○	
22	27.92[1.099]	25.40[1.000]	○	
24	30.46[1.199]	27.94[1.100]	○	
28	35.54[1.399]	33.02[1.300]	○	

TOLERANCE .0=±.0.30 [.012] .00=±0.20 [.008] .000=±.xxx .0000=±. ANG.=±3°	DRAWER <i>SVB</i> CHECK <i>LSGN</i> APP'D <i>Katherlin</i>	Astron ASTRON TECHNOLOGY CORP. NAME DIP SOCKET 2.54mm PITCH, DUAL IN-LINE, P.C.B. MOUNT, VERTICAL MACHINE PIN (0.3")
UNITS : mm [inch]	PRODUCT SPEC. —	
SCALE NONE	SIZE A4	DRAW NO. C240-0204
SHEET 1 OF 1	REV. B	12014